

# INFINITY

EVENTS

# INFINITY HOTEL & CONFERENCE RESORT MUNICH LOCATION









## INFINITY TWO

Foyer  
Tegernsee I-IV  
Breakout I-X  
SEASONS Buffet restaurant

## INFINITY ONE

Meeting Area | Ground floor  
Meeting Area | 1st floor  
Executive Meeting Area | 2nd floor  
VIKTUALIEN Buffet restaurant  
CHALET Private Dining

## BALLHAUSFORUM

Auditorium/Arena  
Foyers (Platzl)  
Winter garden

## CENTER

Bar  
SPA  
Terrace

## HIRSCHALM

Alpine cabin  
Beer garden

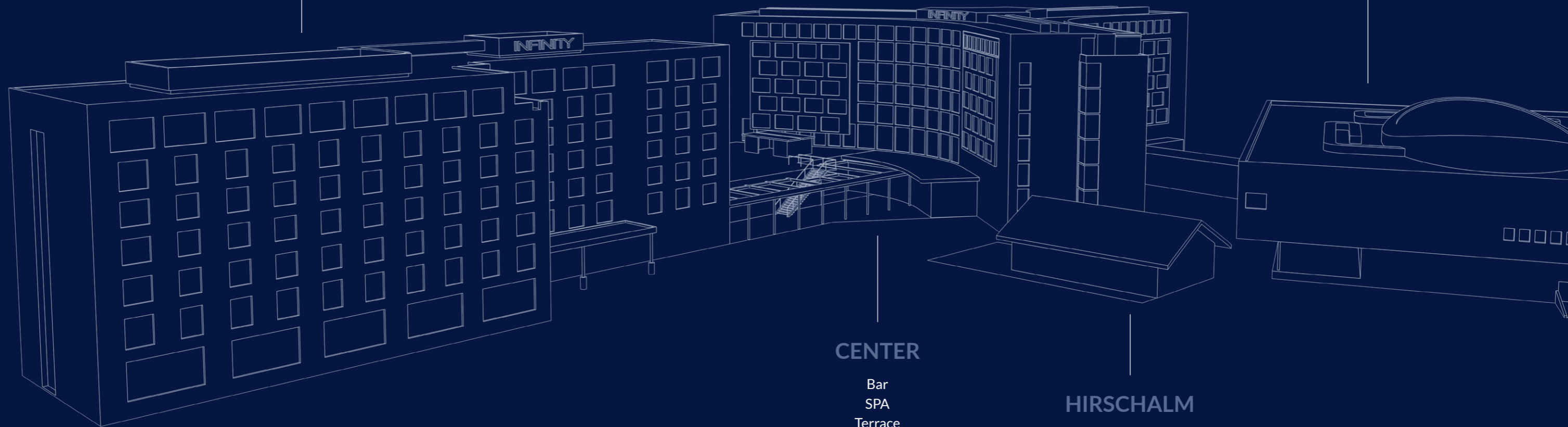



**INFINITY ONE**  
1st floor

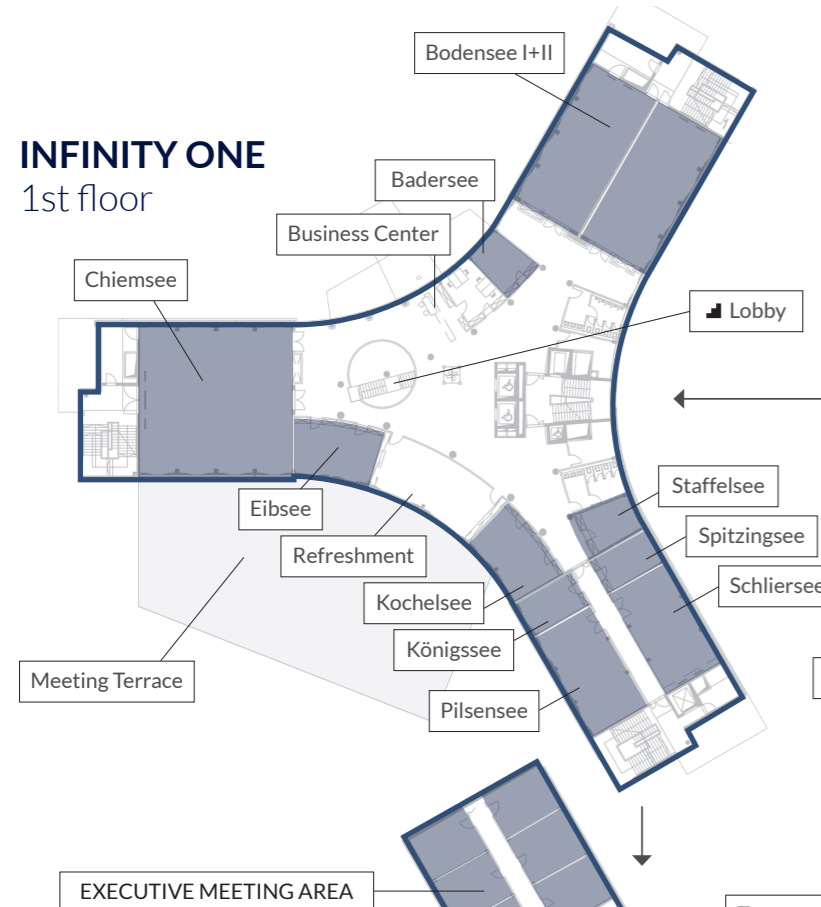

**INFINITY ONE**  
2nd floor

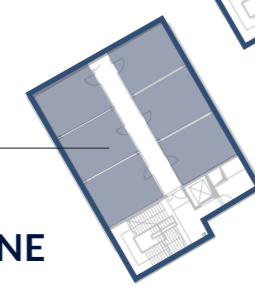

**INFINITY ONE**  
Ground floors

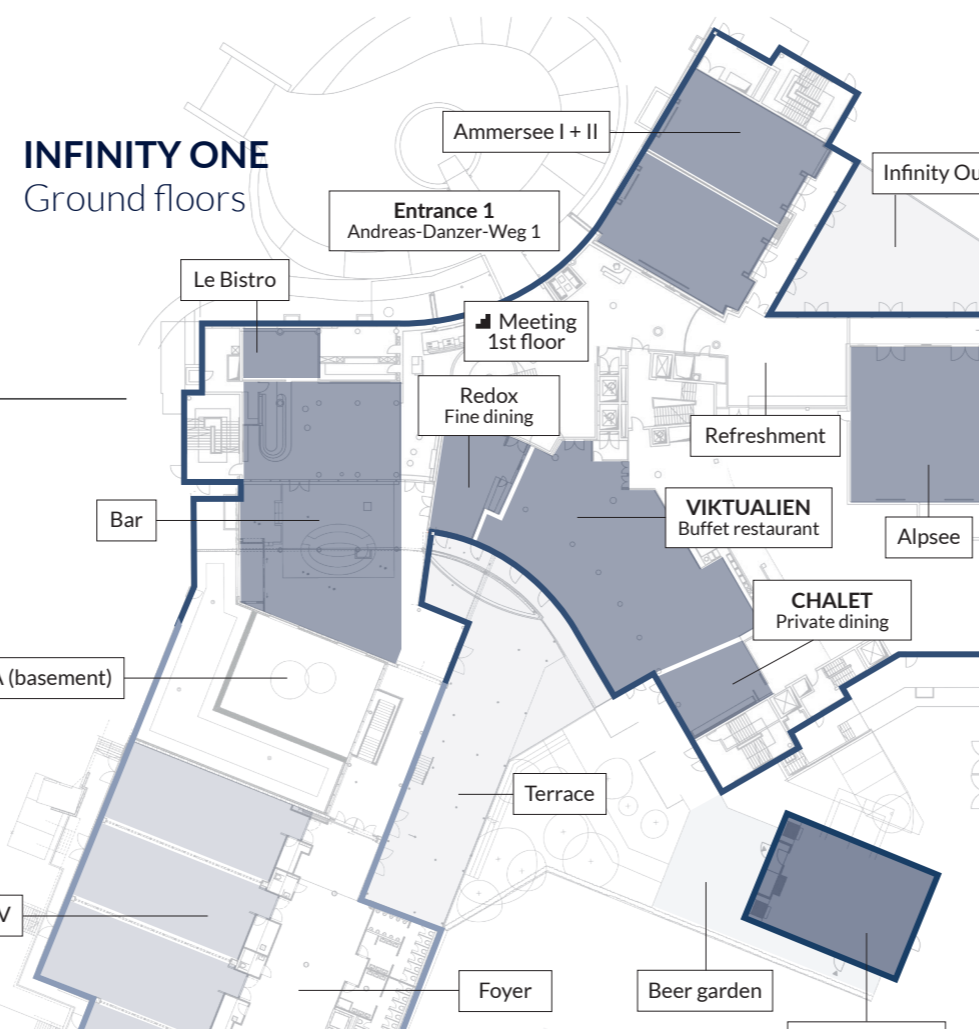

**INFINITY TWO**  
Ground floors

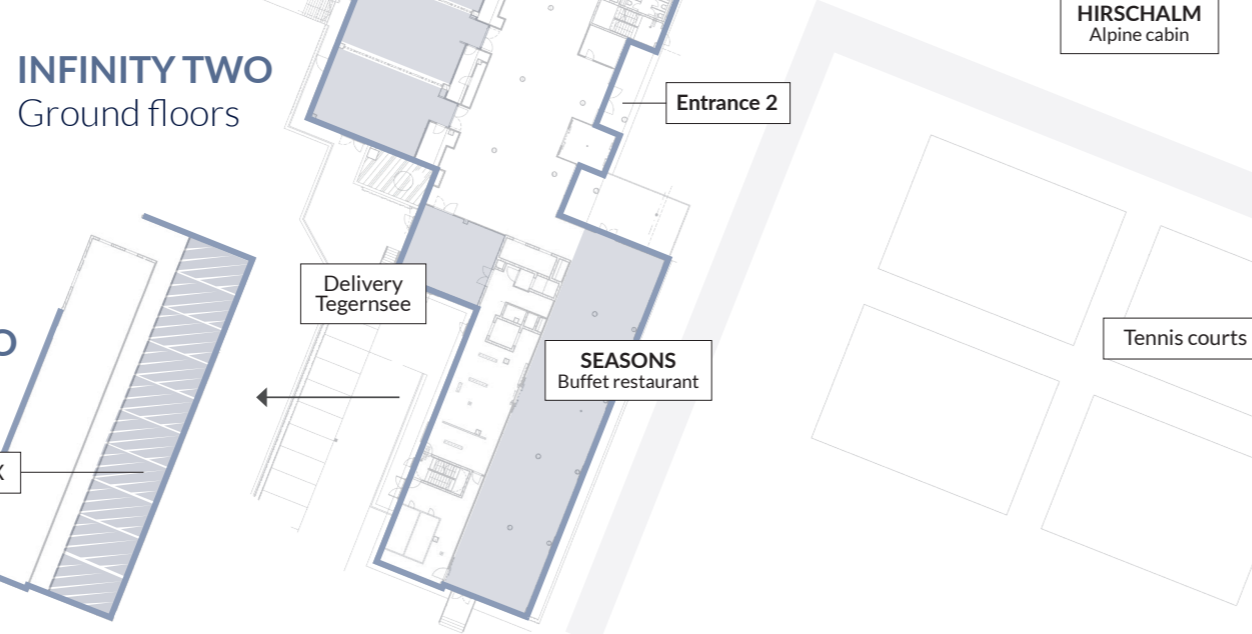

**INFINITY TWO**  
1st floor

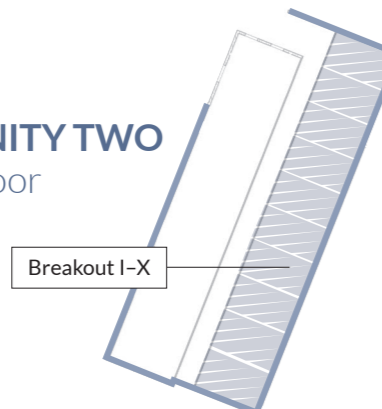

**BALLHAUSFORUM**  
Ground floor

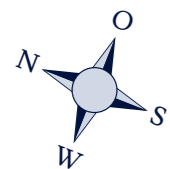
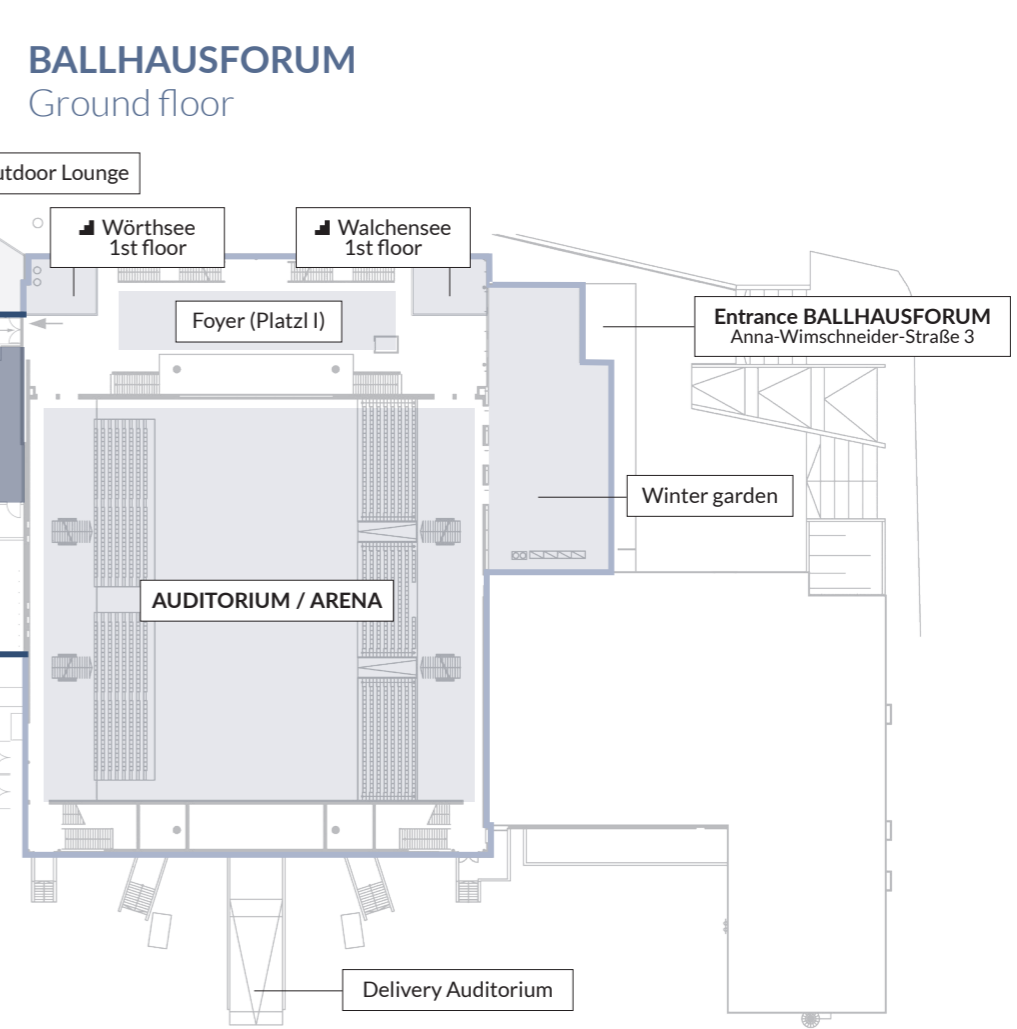

Parking spaces

Tennis courts

SEASONS Buffet restaurant

HIRSCHALM Alpine cabin

Entrance 2

Delivery Tegernsee

Breakout I-X

EXECUTIVE MEETING AREA

Chiemsee

Business Center

Badensee

Bodensee I+II

Staffelsee

Spitzingsee

Schliersee

Eibsee

Refreshment

Kochelsee

Königssee

Pilsensee

Meeting Terrace

SPA (basement)

Tegernsee I-V

Foyer

Beer garden

Terrace

VIKTUALIEN Buffet restaurant

Alpsee

CHALET Private dining

Redox Fine dining

Refreshment

Bar

Le Bistro

Entrance 1  
Andreas-Danzer-Weg 1

Ammersee I + II

Infinity Outdoor Lounge

Würthsee 1st floor

Walchensee 1st floor

Foyer (Platz I)

Entrance BALLHAUSFORUM  
Anna-Wimschneider-Straße 3

Winter garden

AUDITORIUM / ARENA

Delivery Auditorium





INFINITY ONE | Ground floor  
**MEETING AREA**





INFINITY ONE | Ground floor

## MEETING AREA

Alpsee	257 m <sup>2</sup> (2,766 sq.ft) – 280 pax
Ammersee I+II (separable)	314 m <sup>2</sup> (3,380 sq.ft) – 330 pax
Ammersee I	163 m <sup>2</sup> (1,755 sq.ft) – 150 pax
Ammersee II	149 m <sup>2</sup> (1,604 sq.ft) – 150 pax
INFINITY Outdoor Lounge	270 m <sup>2</sup> (1,830 sq.ft)
Refreshment	170 m <sup>2</sup> (2,906 sq.ft)

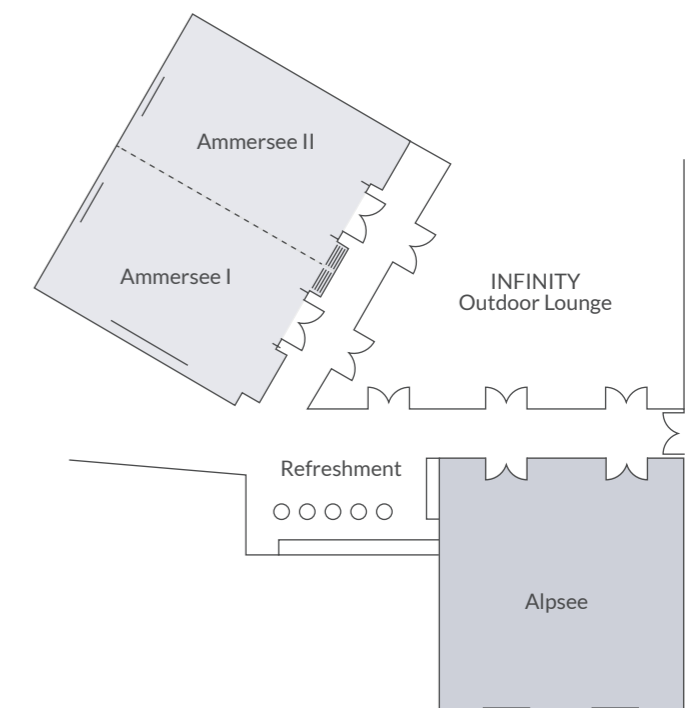





INFINITY ONE | 1st floor  
**MEETING AREA**





INFINITY ONE | 1ST FLOOR

**MEETING AREA**

Chiemsee	229 m <sup>2</sup> (2,465 sq.ft) – 250 pax
Meeting Terrace	230 m <sup>2</sup> (2,476 sq.ft)
Eibsee	49 m <sup>2</sup> (527 sq.ft) – 40 pax
Kochelsee	46 m <sup>2</sup> (495 sq.ft) – 40 pax
Königssee	23 m <sup>2</sup> (247 sq.ft) – 18 pax
Pilsensee	75 m <sup>2</sup> (807 sq.ft) – 60 pax
Schliersee	75 m <sup>2</sup> (807 sq.ft) – 60 pax
Spitzingsee	24 m <sup>2</sup> (258 sq.ft) – 18 pax
Staffelsee	26 m <sup>2</sup> (279 sq.ft) – 18 pax
Bodensee I & II (separable)	228 m <sup>2</sup> (2,454 sq.ft) – 250 pax
Bodensee I	114 m <sup>2</sup> (1,227 sq.ft) – 125 pax
Bodensee II	114 m <sup>2</sup> (1,227 sq.ft) – 125 pax
Badersee	21 m <sup>2</sup> (226 sq.ft) – 18 pax
Refreshment	80 m <sup>2</sup> (861 sq.ft)

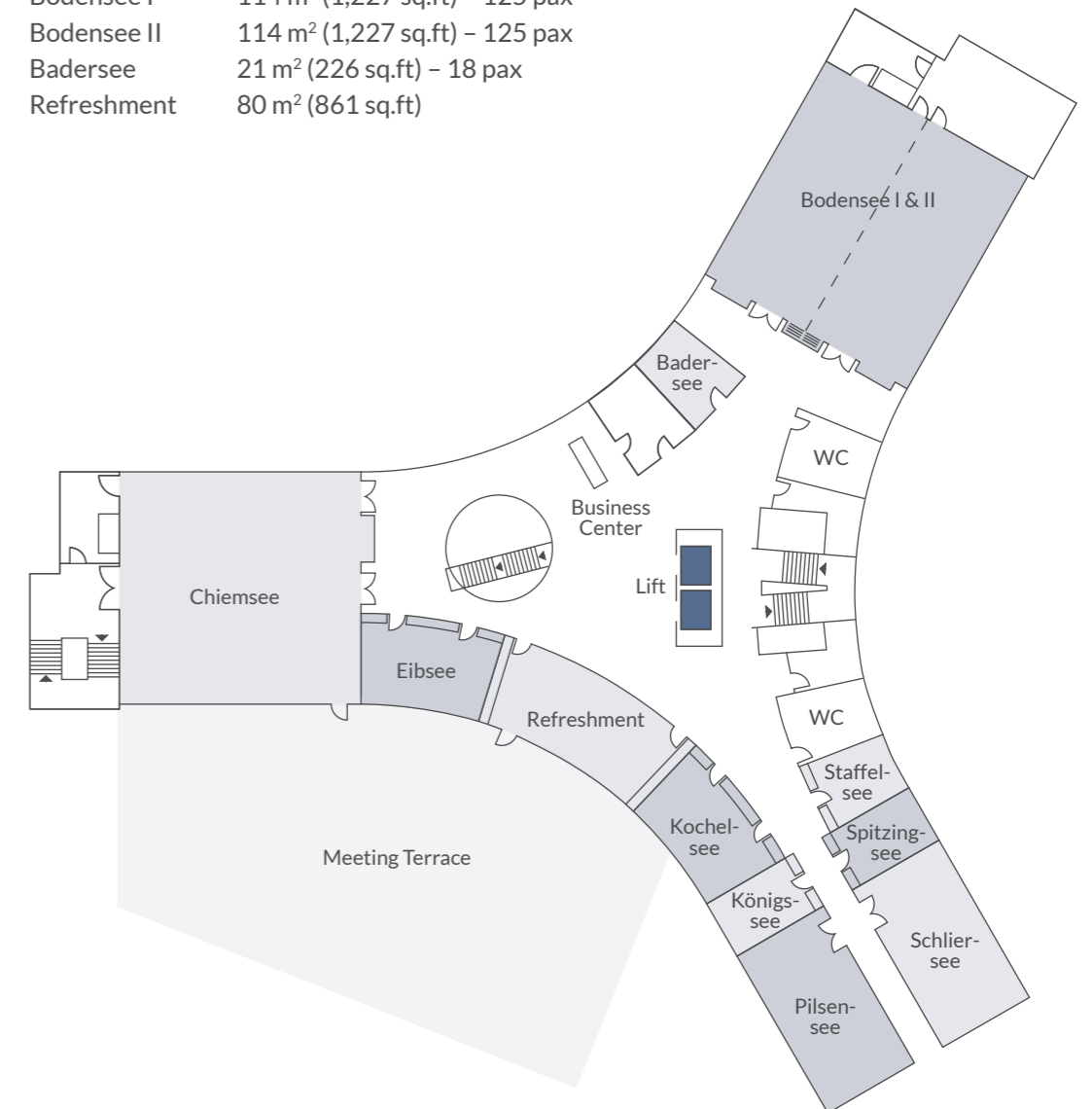



INFINITY ONE | 2nd floor  
**EXECUTIVE MEETING AREA**







INFINITY ONE | 2nd floor

### EXECUTIVE MEETING AREA

Gold	42 m <sup>2</sup> (452 sq.ft) - 18 pax
Green	46 m <sup>2</sup> (495 sq.ft) - 16 pax
Blue	56 m <sup>2</sup> (603 sq.ft) - 16 pax
Orange	64 m <sup>2</sup> (689 sq.ft) - 16 pax
Lounge	20 m <sup>2</sup> (215 sq.ft)
Refreshment	20 m <sup>2</sup> (215 sq.ft)

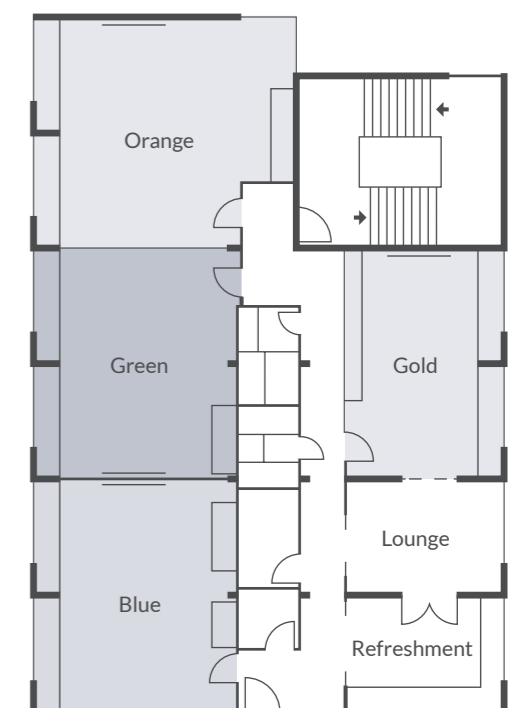





INFINITY ONE | Ground floor  
**VIKTUALIEN Buffet restaurant**





INFINITY ONE | Ground floor  
**VIKTUALIEN Buffet restaurant**

Viktualien 185 pax  
Chalet 45 pax

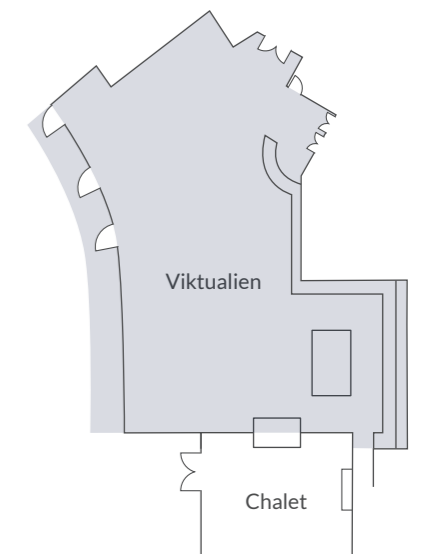



INFINITY TWO | Ground floor  
**FOYER**





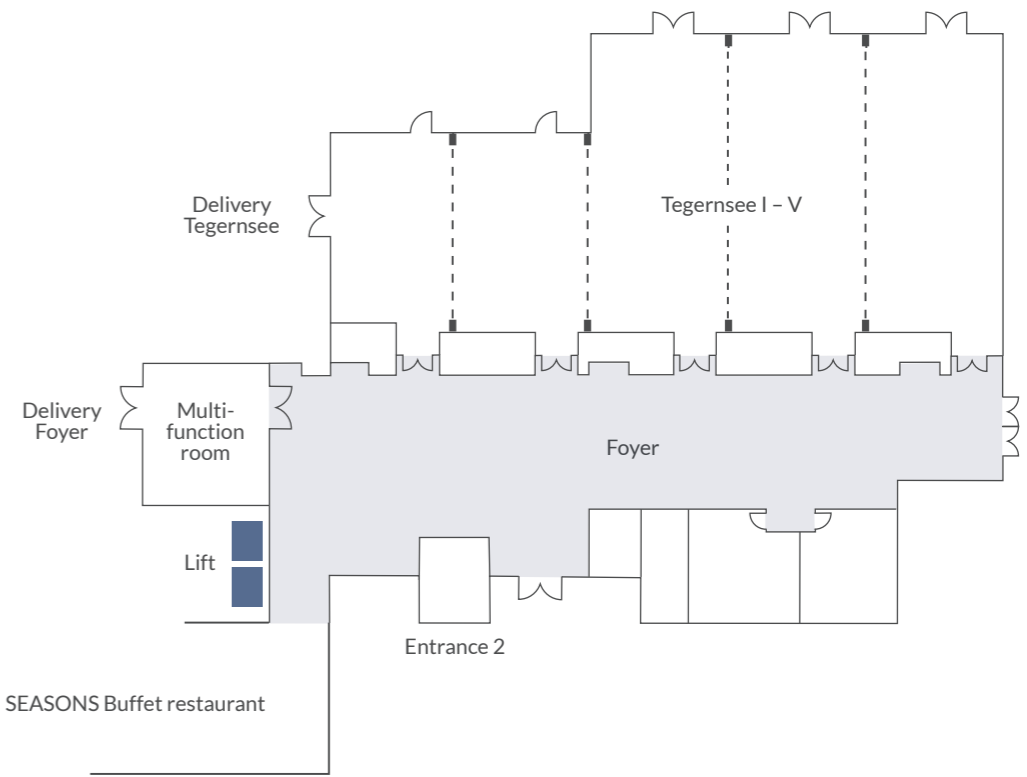

INFINITY TWO | Ground floor

**FOYER**

490 m<sup>2</sup> (5,274 sq.ft)  
3 Refreshment Stations







INFINITY TWO | Ground floor  
**TEGERNSEE I-V**



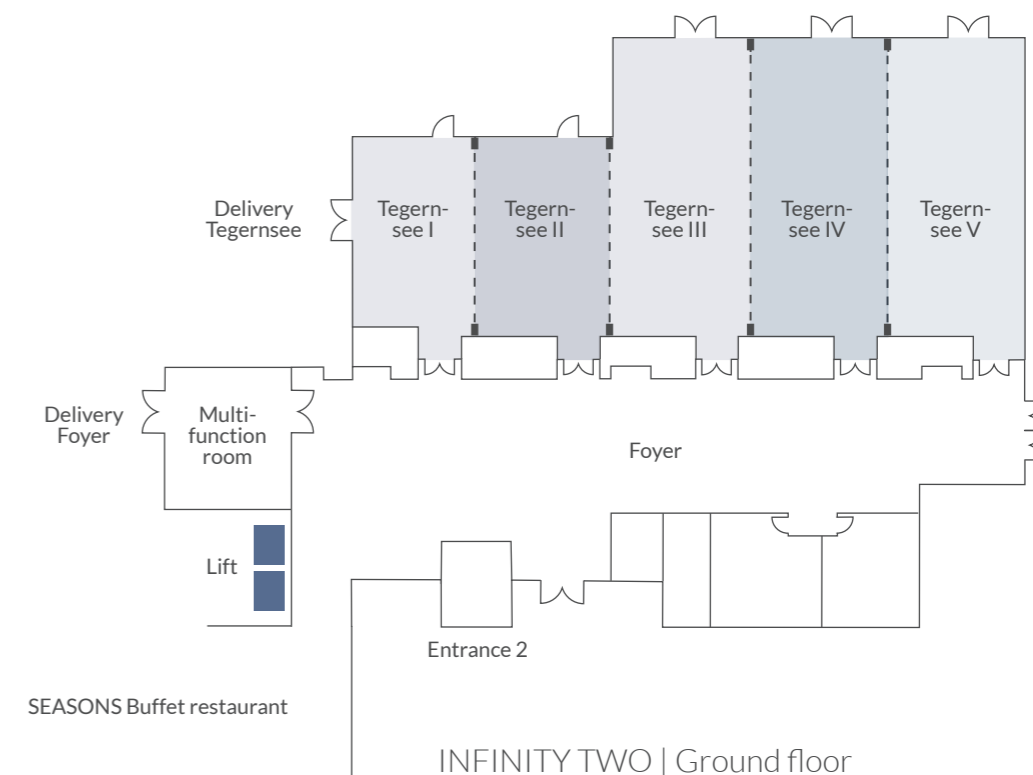

INFINITY TWO | Ground floor

**TEGERNSEE**

Tegernsee I-V (separable)	693 m <sup>2</sup> (7,459 sq.ft) – 655 pax
Tegernsee I	93 m <sup>2</sup> (1,001 sq.ft) – 90 pax
Tegernsee II	93 m <sup>2</sup> (1,001 sq.ft) – 90 pax
Tegernsee III	155 m <sup>2</sup> (1,668 sq.ft) – 150 pax
Tegernsee IV	155 m <sup>2</sup> (1,668 sq.ft) – 150 pax
Tegernsee V	155 m <sup>2</sup> (1,668 sq.ft) – 150 pax



# INFINITY TWO | 1st floor BREAKOUT



INFINITY TWO | 1st floor

## BREAKOUT I-X

Breakout I-X 18 m<sup>2</sup>(194 sq.ft) - 8 pax

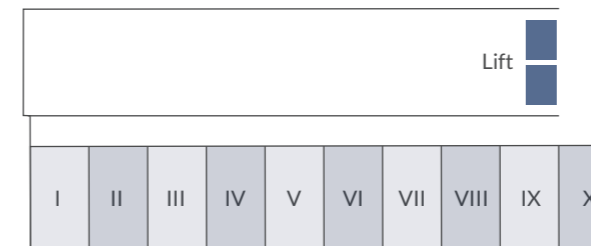



INFINITY TWO | Ground floor  
**SEASONS Buffet restaurant**





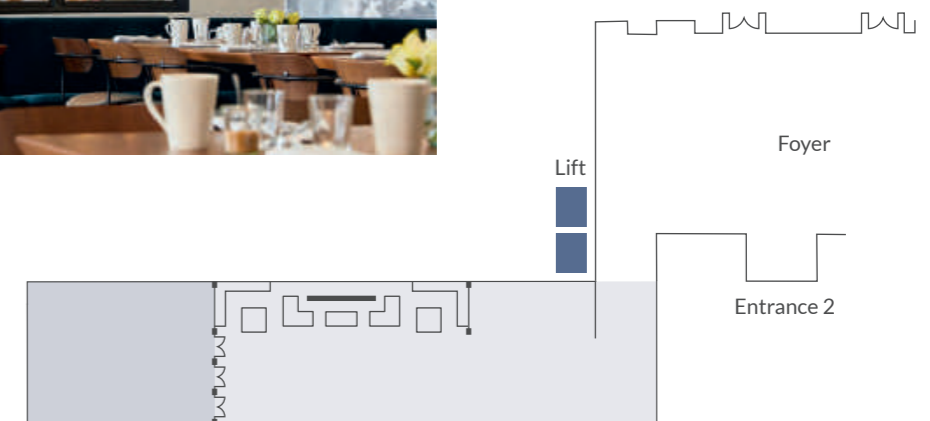

INFINITY TWO | Ground floor  
**SEASONS Buffet restaurant**

190 pax (Separée 65 pax)



# INFINITY CHALET Private Dining



## INFINITY ONE | Ground floor CHALET Private Dining

Chalet 45 pax  
Viktualien 185 pax

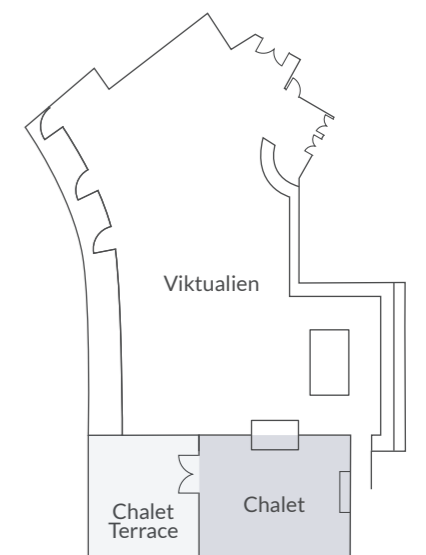



INFINITY  
HIRSCHALM







INFINITY  
**HIRSCHALM & BEER GARDEN**

Alpine cabin 190 pax

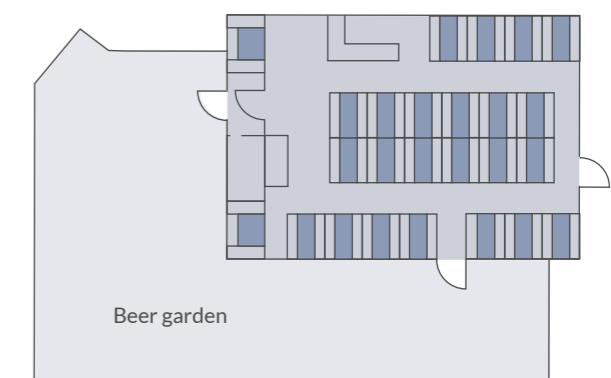



# INFINITY BALLHAUSFORUM

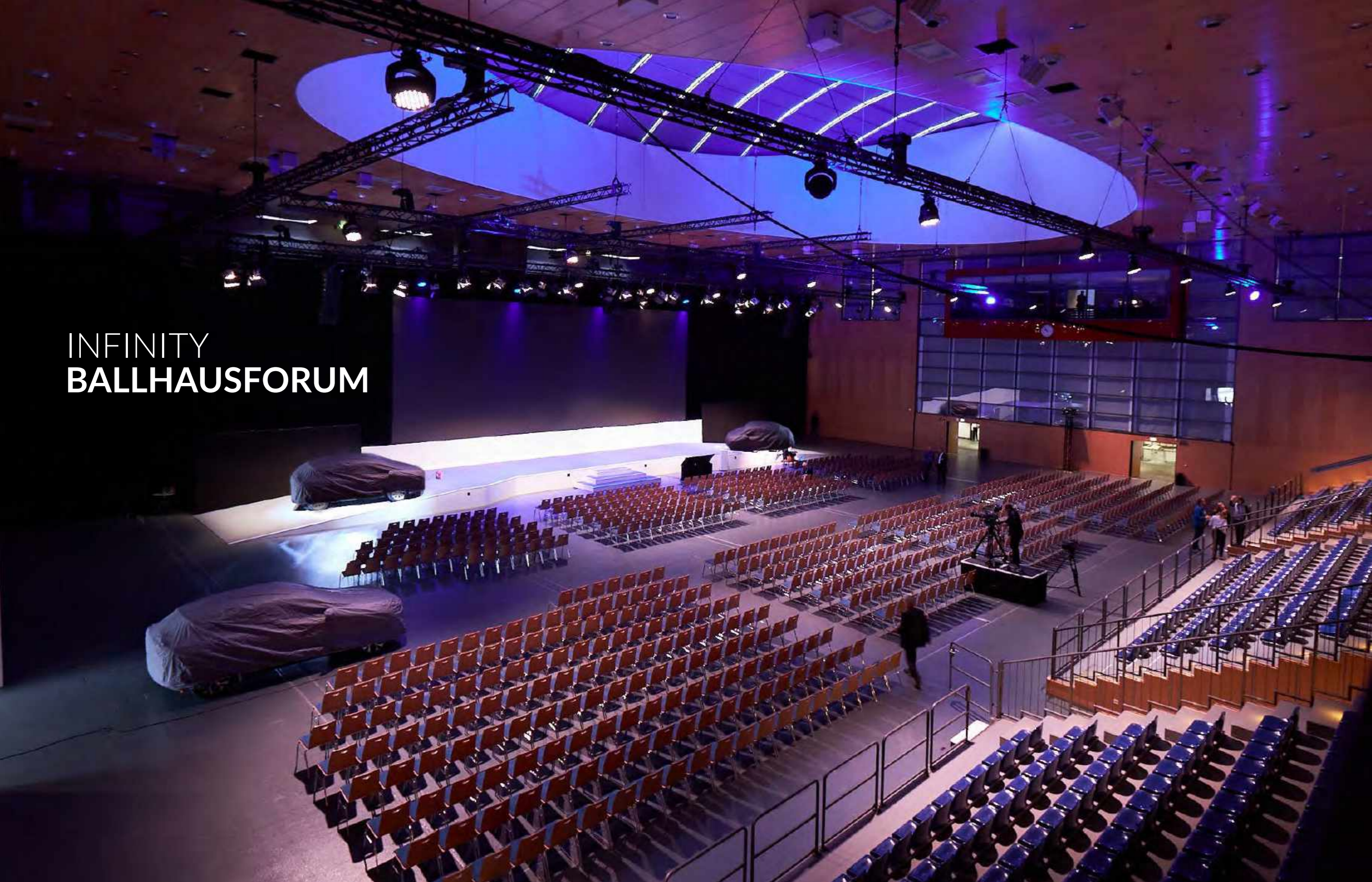



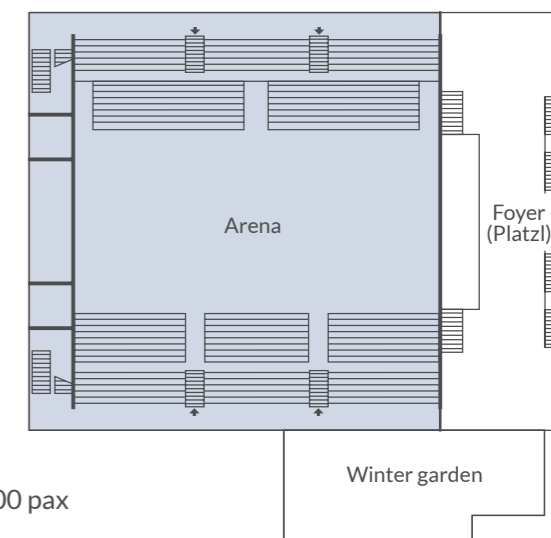

INFINITY  
**BALLHAUSFORUM ARENA**

Arena	1.340 m <sup>2</sup> (14,424 sq.ft) – 1,400 pax
Stand south	1.012 pax
Stand north	972 pax



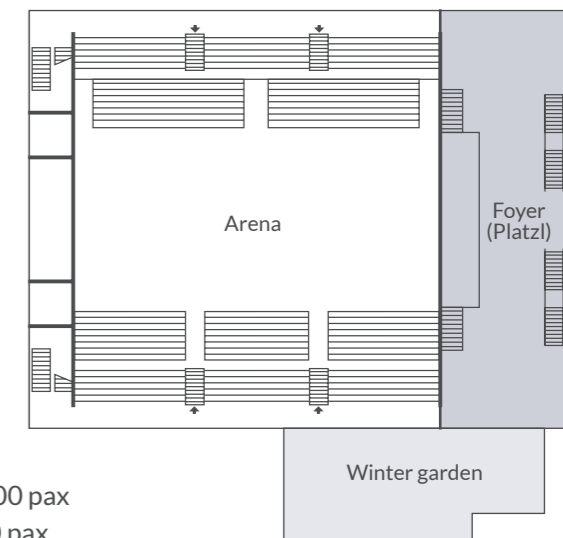
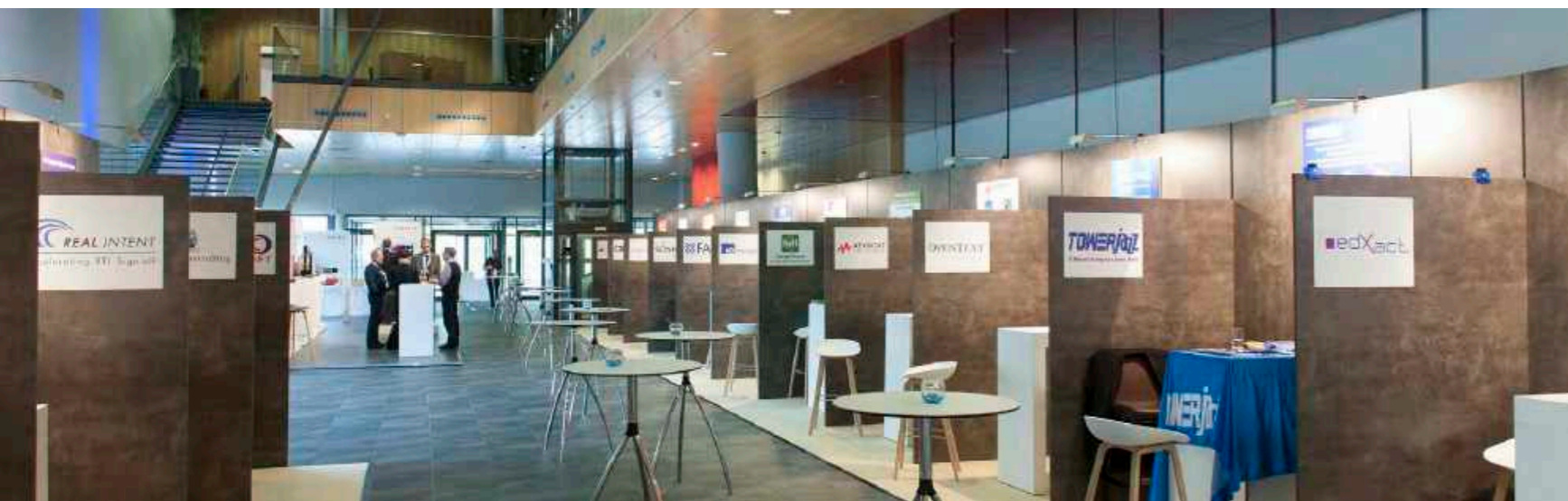

INFINITY  
**BALLHAUSFORUM FOYERS**

Foyer Platzl I, Ground floor 614 m<sup>2</sup> (6,609 sq.ft) – 1,200 pax  
 Foyer Platzl II, 1st floor 480 m<sup>2</sup> (5,167 sq.ft) – 600 pax  
 Winter garden, Ground floor 325 m<sup>2</sup> (3,498 sq.ft) – 350 pax



**7,500 m<sup>2</sup>** (80,729 sq.ft)  
TOTAL EVENT SPACE

SOUTHERN GERMANY'S

**LARGEST**  
EVENT HOTEL

**9** RESTAURANTS & BARS

**439** ROOMS & SUITES

PERFECT  
INFRASTRUCTURE

PROFESSIONAL  
EVENT MANAGERS  
**ON SITE**

**43** MEETING ROOMS  
INCLUDING **3** EVENT LOCATIONS  
(HIRSCHALM, BHF, TEGERNSEE)

**1,000**  
COMPLIMENTARY PARKING SPACES

**SPACIOUS FOYERS AND OUTSIDE AREAS**



# INFINITY

HOTEL & CONFERENCE RESORT MUNICH  
Andreas-Danzer-Weg 1 – 3 · 85716 Unterschleißheim · Deutschland  
T +49 89 999 56 0 · [info@infinity-munich.de](mailto:info@infinity-munich.de)  
[infinity-munich.de](http://infinity-munich.de)